

EVAK4

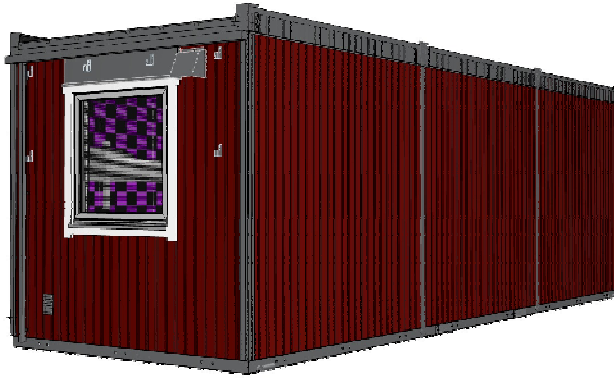

- 1 Dining table 700*1400
- 2 Minikitchen, wall cabinet with shelve
- 3 Radiator
- 5 Chair, black plastic
- 8 Kitchen cabinet with drawer
- 18 Fridge
- 20 Microwave oven
- 22 Fresh air diffuser
- 23 Wall fan
- 28 Lockers or wardrobe cabinet
- 32 Basin with mirror
- 34 Shower cabin with curtain, soap holder and shower set
- 36 WC with toilet paper holder
- 46 Waterheater

ROOF U=0,218 W/m²K

- PVC membrane with a glass fibre carrier
- Particle board OSB 12mm
- Rafters 45x23-84mm c-c 434mm
- Asphalt impregnated wind barrier paper
- Wooden frame 45x145mm with glass wool λ35
- Particle board 10mm
- PU plastic vapor barrier 0.2 mm, UV-resistant
- Inner Panel "Forestia White Structure" 12,5mm

WALL U=0,209 W/m²K

- External siding profile UYS 18x120mm
- Asphalt impregnated wind barrier paper
- Particleboard 12mm OSB
- Wooden frame 45x145mm with glass wool λ35
- PU plastic vapor barrier 0.2 mm, UV-resistant
- Inner Panel "Forestia fiberglass Grey" 12,5mm

FLOOR U=0,212 W/m²K

- PVC Vinyl flooring, Tarkett
- Chipboard Durelis P5 21mm, screwed and glued
- Wooden frame 45x145mm with glass wool λ35
- Particle board OSB3 8mm

Roof angle	1:60
Weight	Ca 5400kg
Transportation measures	2950x8570x3000
Inside measures	2620x8120x2400

SYSTEMS

Electricity	230V
Ventilation	100Ø
Water	16Ø
Sewer	110Ø

Building area:	24,3 m²
Neto area:	19,7 m²

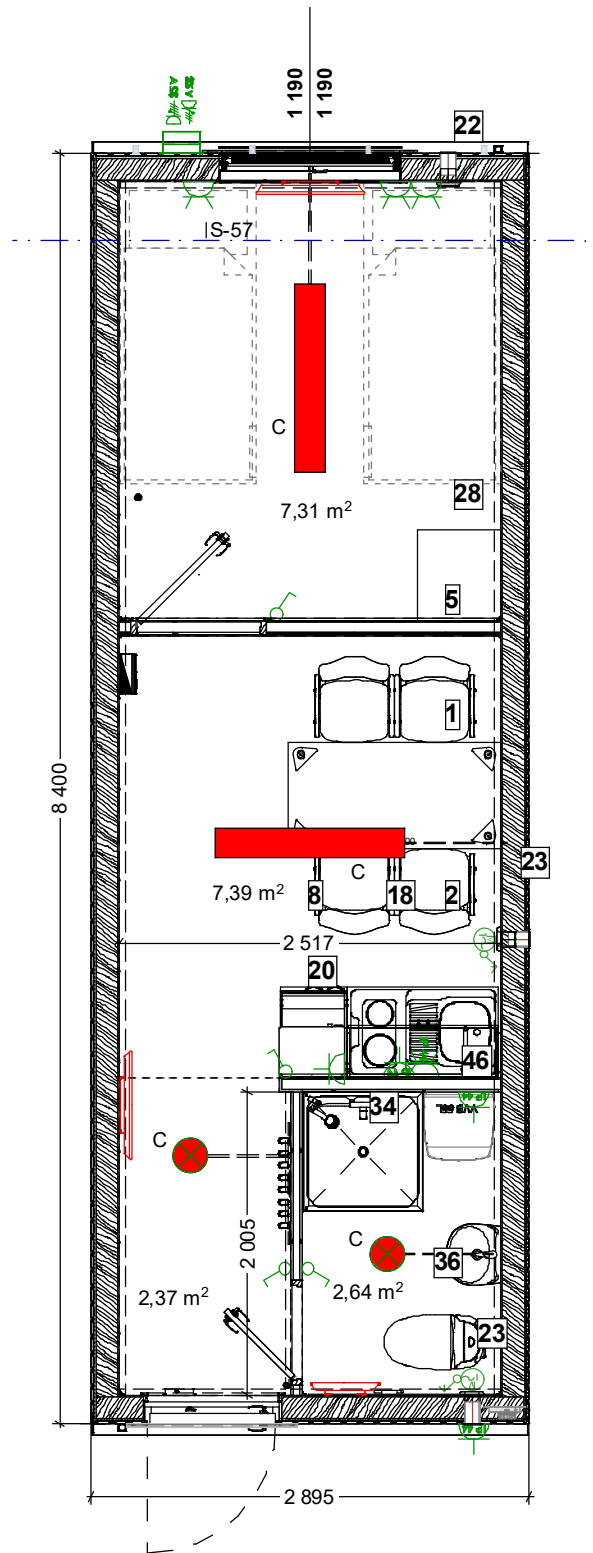

project name	Temporärt mobilt boende, Temporary mobile housing 4.per				Modulhuset AB			
drawing name	PLAN, 3D							
project address								
client								
project number		status	Tender design					
drawing number	02	revision number			checked by			2/2
date	17.08.2018	designed by		project manager	scale	1:50, 1:395,80	sheet	A4